

SCHIEBEL
 SMARTCON CSC eW
 Thyristor reversing contactors

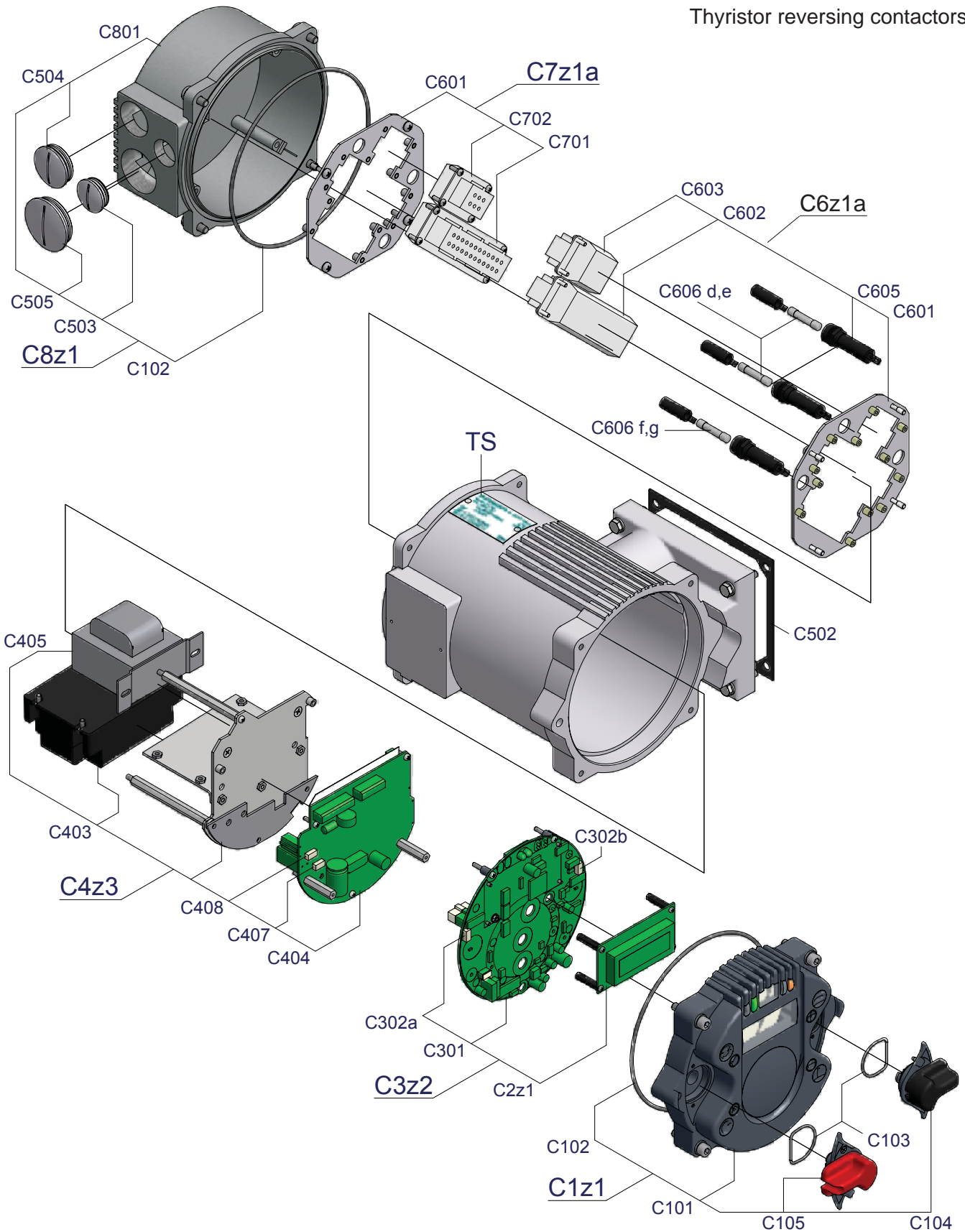

Part No.	Type	Designation
C1z1	B	CSC E-Cover complete
C101	B	E-Cover
C102	VPE	Seal E-Cover - packing with 10pcs.
C103	VPE	O-Ring seal - packing with 10pcs.
C104	B	Switch black
C105	B	Switch red
C2z1	E	Display
C3z2	B	Logic board complete
C301	B	Logic board
C302a	VPE	Fuse logic board 375mA - packing with 10pcs.
C302b	VPE	Fuse logic board 500mA - packing with 10pcs.
C4z3	B	Power supply unit complete with Thyristor reversing contactors up to 3,0kW motor power
C403	B	Thyristor reversing contactors up to 3,0kW motor power
C404	E	Basic board
C405	E	Transformer
C407	VPE	Fuse for basic board 1A (slow) - packing with 10pcs.
C408	VPE	Fuse for basic board 500mA (slow) - packing with 10pcs.
C502	VPE	Flat gasket C-housing
C503	VPE	Screw plug M25x1,5 - packing with 10pcs.
C504	VPE	Screw plug M32x1,5 - packing with 10pcs.
C505	VPE	Screw plug M40x1,5 - packing with 10pcs.
C6z1a	B	Plug unit complete (male)
C601	E	Plug mounting plate
C602	E	Control plug Han24E (male)
C603	E	Motor plug Han6E (male)
C605	E	Fuse holder
C606d	VPE	Fuse 20A (fast blow) for motor power less than 3,0kW (2pcs. per unit required) - packing with 10pcs.
C606e	VPE	Fuse 12,5A (slow) for motor power = 3,0kW (2pcs. per unit required) - packing with 10pcs.
C606f	VPE	Fuse 100mA (slow) for power supply over 3x400V; 50Hz - packing with 10pcs.
C606g	VPE	Fuse 125mA (slow) for power supply up to 3x400V; 50Hz - packing with 10pcs.
C7z1a	B	Plug unit complete (female)
C701	E	Control plug Han24E (female)
C702	E	Motor plug Han6E (female)
C8z1	B	A-Cover complete

Teil	Type	Designation
C801	E	A-Cover
TS	B	Spare name plate with blind rivets
11.4.2	B	Smartcon control unit complete with original Schiebel factory parameters (serial no. is required)
CSCSI-USB	B	Smartcon Interface & CD with Software for Windows 2000/XP/Vista to save or transfer adjusted actuator data via infrared USB 2.0 interface for PC, CD with installation instructions.

ATTENTION:

Please state for each spare part order our 7-8 digits long fabrication number and actuator type (see actuator name plate near the hand lever). Only original SCHIEBEL spare parts should be used. Failure to use original spare parts voids the warranty and exempts SCHIEBEL from any liability. Delivered spare parts may slightly vary from the representation.

Type E = single part
Type B = assembly group

VPE = package

o.r. = on request
o.i.a. = only in assembly group available

Sales and delivery according to our general conditions of sale.

Issue
01/2011

